

Air reservoir 950 ...



Application

For all vehicles with compressed air braking systems.

Purpose

Storage of the compressed air delivered from the compressor.

Design

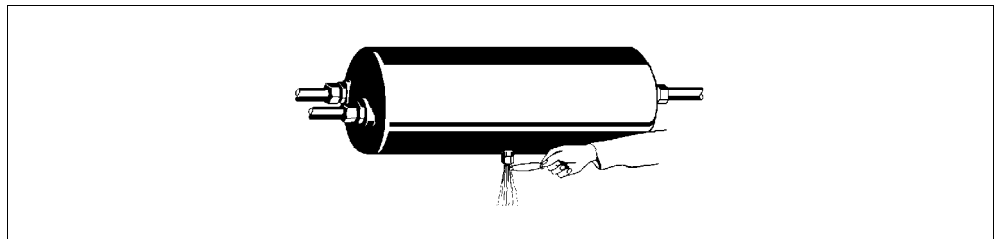

The reservoir consists of the cylindrical portion in the centre with welded-in arched bases and screw necks for connecting pipes.

A further port is located at the centre section where a draining facility can be attached for regular draining of condensate.

The material used is sheet steel to specification R St 37-2. The inside surface of the reservoir is coated with a synthetic resin to provide protection against corrosion. The outside surface is primed with a synthetic resin.

A plate is located at one end, indicating the name and address of the supplier, the supplier's part number, the year of manufacture, the maximum operating pressure [bar], the capacity [litres], the serial number, test mark, the volume x diameter and – for some types only – DIN 74 281.

Maintenance

- Drain the air reservoir daily.



We recommend using drain valves which are available for both manual and automatic actuation.

Installation recommendation

- Attach the clamp rings so that the connecting seams do not touch the base and the reservoir is not subjected to any tension that could jeopardize operational safety.
The fastening is done using straps or the brackets of the reservoir.
Put insulation strips between the reservoir and the straps if necessary.
- Install the reservoir horizontally or vertically.
Make sure that one drain pipe is located at the lowest point of the reservoir.

Air reservoir 950 ...

Make sure that any condensation can be emptied and/or the collection of condensation is prevented.

→ The reservoir plate must be easily legible in the specified installation point when the reservoir is installed.

! No heat treatment or welding is to be done on the walls of the reservoir that are under pressure.

Installation dimensions

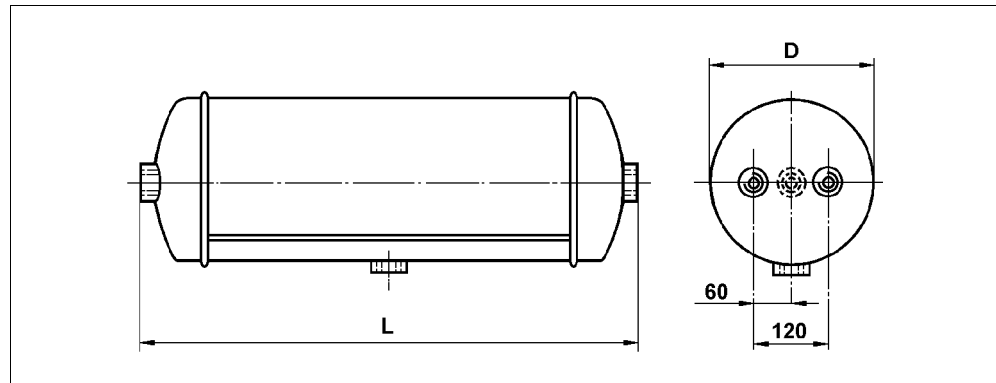

Port threads

M 22x1.5 - 12 deep

Technical data

Order number	Contents [litres]	Length L [mm]	Diameter D [mm]	Max. operating pressure [bar]	Weight [kg] ±10 %
950 405 001 0	4,5	185	206	15,5	3,0
950 410 004 0	10	368	206	15,5	4,7
950 420 003 0	20	691	206	15,5	8,0
950 520 003 0	20	495	246	15,5	7,2
950 530 002 0	30	709	246	15,5	10,0
950 537 001 0	37	862	246	15,5	11,9
950 540 001 0	40	927	246	15,5	12,7
950 740 002 0	40	758	276	14,5	11,5
950 560 002 0	60	1365	246	15,5	18,0
950 760 002 0	60	1108	276	14,5	16,2
950 060 003 0	60	893	310	12,5	15,2
950 060 004 0	60	580	396	12,5	16,3
950 080 002 0	80	750	396	12,5	20,5
950 100 002 0	100	915	396	12,5	24,5

Air reservoir 950 ...

Clamping band	Cylinder Ø	Order number
	206	451 999 206 2
	246	451 999 246 2
	276	451 999 276 2
	310	451 999 310 2
	396	451 999 396 2

Rubber spacer: 451 999 999 0 (50 m roll)