

Membranzylinder Brake Chamber

423 109

1

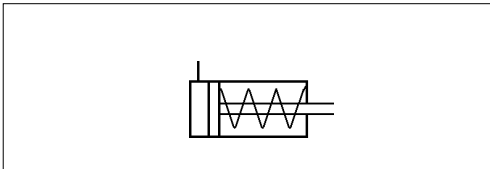
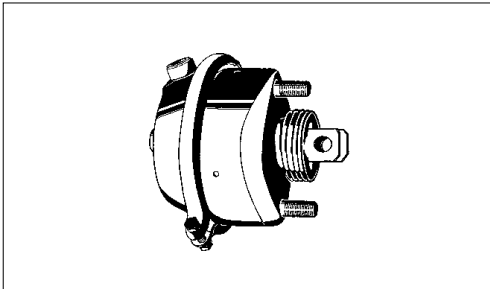

Technische Daten / Technical Data:

Type	27
Betriebsdruck Operating Pressure	max. 8 bar
Zulässiges Medium Permissible Medium	Luft / air
Therm. Anwendungsbereich Operating temperature range	-40°C bis/to +80°C
Hub Stroke	siehe Tabelle see table
Druckstangenauslenkung Piston rod deflection	allseitig max. 3° 3° max. all round
Gewinde der Leitungsanschlüsse Thread of pipe connection	M16x1,5

Zweck und Einbauempfehlung:
Siehe 423 003

Purpose and Installation Requirement:
See 423 003

Charakteristik / Characteristic:

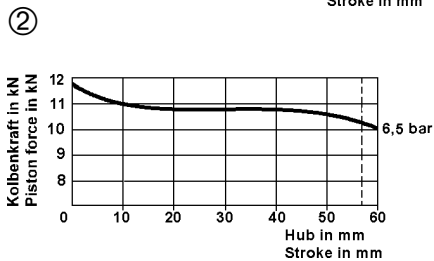
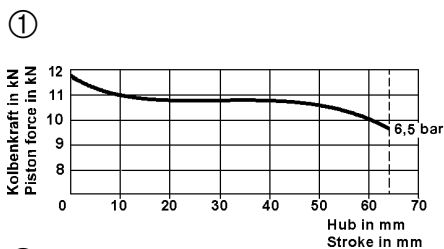

Abmaße / Dimensions:

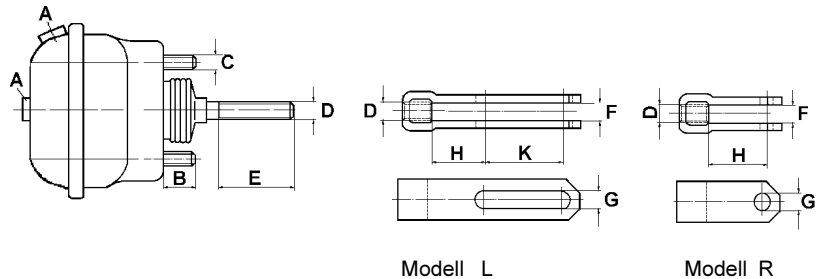

Gabelkopf / Yoke:

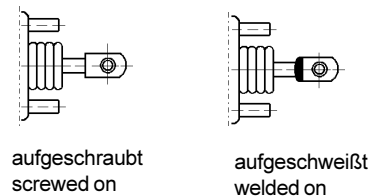

Anschluß / Port:

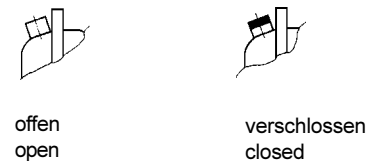

Bestellnummer Part Number	Lage der Anschlüsse Position of ports
423 109 001 0 A= M 16x1,5 B= 38 C= M 16x1,5 D= - E= - F= 14,2 G= 14 H= 31,5 K= -	
	64 1 250 F 8 120,7 R

- Details können versetzt dargestellt sein / Details can be shown out of plane
- Bemerkungen / Comments (AVS= Anti Vibrations Set, wat= wadfähig / fording ability))
- Gabelkopf / Yoke (R= Rundloch/normal hole; L=Langloch/oblong hole, - = ohne/without)
- Abstand Befestigungsbolzen / Distance between bolts
- Betriebsdruck / Operating pressure
- Abdichtung der Kolbenstange / Seal of piston rod..... (F = Faltenbalg / gaiter
S = Scheibe / disk
- = ohne / without)
- Rückstellkraft der Feder / Force of return spring
- Charakteristik / Characteristic
- Hub / Stroke

Membranzylinder

Brake Chamber

423 109

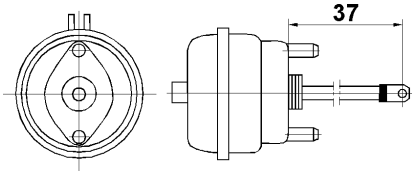
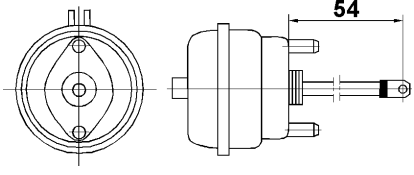
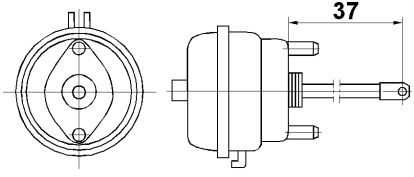
Bestellnummer Part Number	Lage der Anschlüsse Position of ports
423 109 001 0 A= M 16x1,5 B= 38 C= M 16x1,5 D= - E= - F= 14,2 G= 14 H= 31,5 K= -	
	64 1 250 F 8 120,7 R
423 109 002 0 A= M 16x1,5 B= 34 C= M 16x1,5 D= - E= - F= 14,2 G= 14 H= 31,5 K= -	
	64 1 250 F 8 120,7 R
423 109 118 0 A= M 16x1,5 B= 38 C= M 16x1,5 D= M 14x1,5 E= 40 F= 14,2 G= 14 H= 17 K= -	
	57 2 250 F 8 120,7 R wat

Bestellnummer Part Number	Lage der Anschlüsse Position of ports