

# Membranzylinder

## Brake Chamber

423 004

1

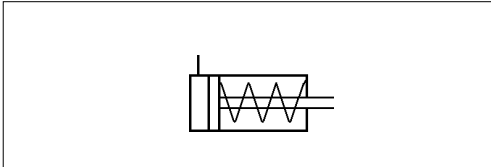
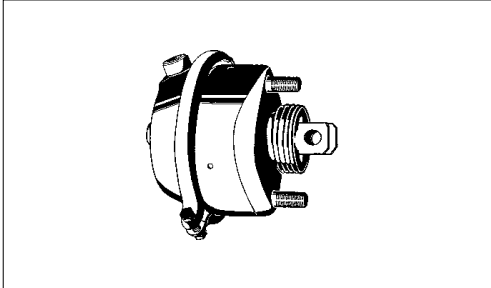

### Technische Daten / Technical Data:

Type	16
Betriebsdruck Operating Pressure	max. 8 bar
Zulässiges Medium Permissible Medium	Luft / air
Therm. Anwendungsbereich Operating temperature range	-40°C bis/to +80°C
Hub Stroke	57 mm
Druckstangenauslenkung Piston rod deflection	allseitig max. 3° 3° max. all round
Gewinde der Leitungsanschlüsse Thread of pipe connection	M16x1,5

**Zweck und Einbauempfehlung:**  
Siehe 423 003

**Purpose and Installation Requirement:**  
See 423 003

**Charakteristik / Characteristic:**

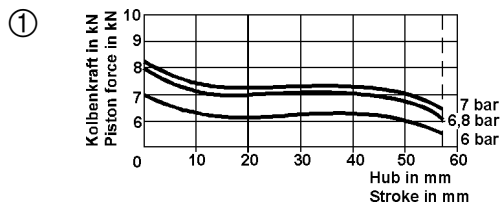

### Abmaße / Dimensions:

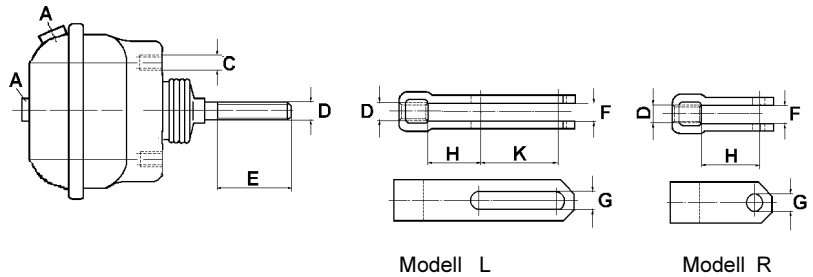

### Gabelkopf / Yoke:

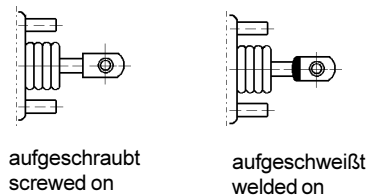

### Anschluß / Port:

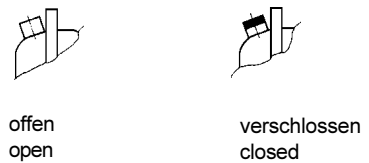

Bestellnummer Part Number	Lage der Anschlüsse Position of ports
423 004 650 0	
A= M 16x1,5	
B= -	
C= M 16x1,5	
D= -	
E= -	
F= 14,2	
G= 14	
H= 20	
K= -	
	57 1 250 F 8 120,7 9

- Details können versetzt dargestellt sein / Details can be shown out of plane
- Bemerkungen / Comments
- Gabelkopf / Yoke ( R= Rundloch/normal hole; L=Langloch/oblong hole, - = ohne/without )
- Abstand Befestigungsbolzen / Distance between bolts
- Betriebsdruck / Operating pressure
- Abdichtung der Kolbenstange / Seal of piston rod..... ( F = Faltenbalg / gaiter  
S = Scheibe / disk  
- = ohne / without )
- Rückstellkraft der Feder / Force of return spring
- Charakteristik / Characteristic
- Hub / Stroke

# Membranzylinder

## Brake Chamber

# 423 004

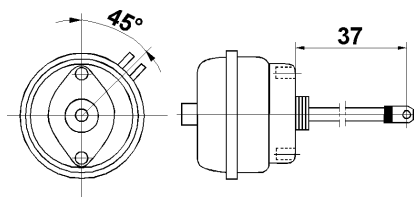
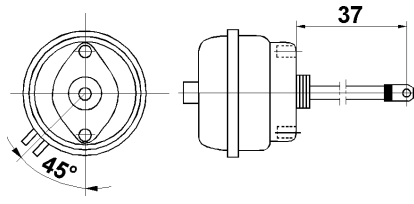
Bestellnummer Part Number	Lage der Anschlüsse Position of ports
423 004 650 0 A= M 16x1,5 B= - C= M 16x1,5 D= - E= - F= 14,2 G= 14 H= 20 K= -	
	57   1   250   F   8   120,7   R
423 004 651 0 A= M 16x1,5 B= - C= M 16x1,5 D= - E= - F= 14,2 G= 14 H= 20 K= -	
	57   1   250   F   8   120,7   R

Bestellnummer Part Number	Lage der Anschlüsse Position of ports