

Einzylinder-Kompressor

Single Cylinder Air Compressor

411 060

1

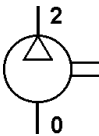
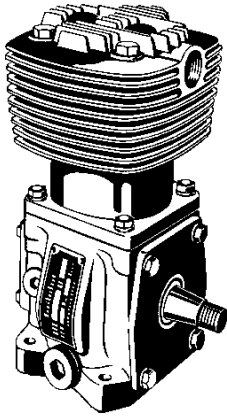

Technische Daten / Technical Data:

Type	HDS
Bohrung Bore	Ø 75 mm
Hub Stroke	24 mm
Hubvolumen Swept volume	106 cm ³
Betriebsdruck Operating pressure	max. 18 bar
Kühlung Cooling	Luft air
Betriebsdrehzahl Normal speed	max. 3000 U/min
Schmierart Type of lubrication	UD
Gewicht Weight	9,0 kg

Zweck:

Erzeugung von Druckluft in Fahrzeugen.

Einbauempfehlung:

siehe Broschüre 826 001 099 3

Purpose:

To generate compressed air in vehicles.

Installation Requirement:

see brochure 826 001 099 3

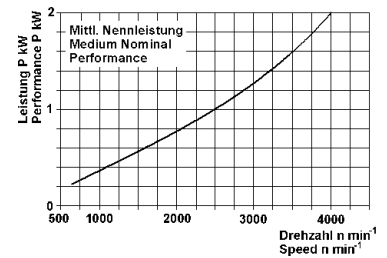
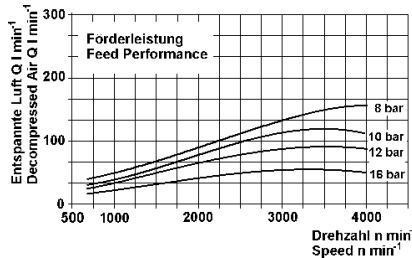

Einbaumaße / Installation:

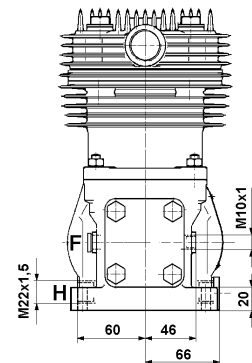
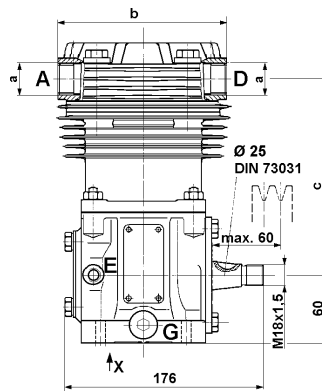

Type: ... 847 0

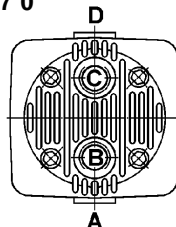

Ansicht / View X

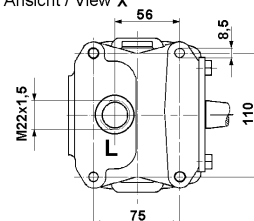

Bestellnummer Part Number	Anschlüsse / Ports									Maße / Dimensions			Bemerkungen Comments
	A	B	C	D	E	F	G	H	L	a	b	c	
411 060 805 0	0	0*	2	2*	81*	81	82*	82*	82*	M 26x1,5	125	166	
411 060 847 0	2	2*	0	0*	81*	81	82*	82*	82	M 26x1,5	125	166	

* mit Stopfen verschlossen / closed with plug