

Einzylinder-Kompressor

Single Cylinder Air Compressor

411 015

1

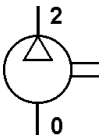
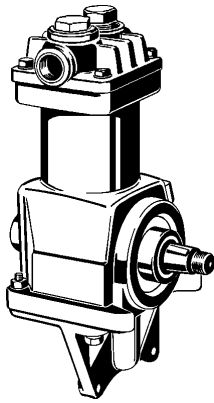

Technische Daten / Technical Data:

Bohrung Bore	Ø 75 mm
Hub Stroke	34 mm
Hubvolumen Swept volume	150 cm ³
Betriebsdruck Operating pressure	siehe Tabelle see table
Kühlung Cooling	Luft air
Betriebsdrehzahl Normal speed	siehe Tabelle see table
Schmierart Type of lubrication	UD
Gewicht Weight	9,0 kg

Zweck:

Erzeugung von Druckluft in Fahrzeugen.

Einbauempfehlung:

siehe Broschüre 826 001 099 3

Purpose:

To generate compressed air in vehicles.

Installation Requirement:

see brochure 826 001 099 3

n = 2300 U/min

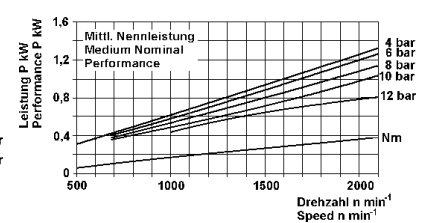
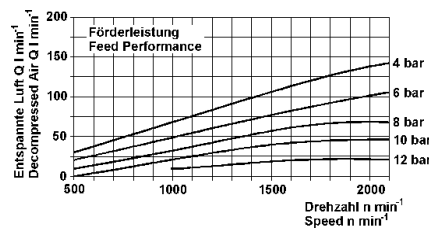

n = 2600 U/min

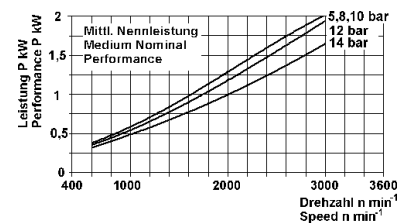
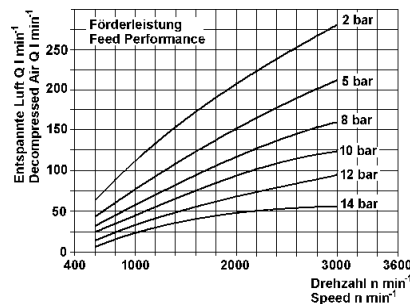

Einzylinder-Kompressor

Single Cylinder Air Compressor

411 015

Einbaumaße / Installation:

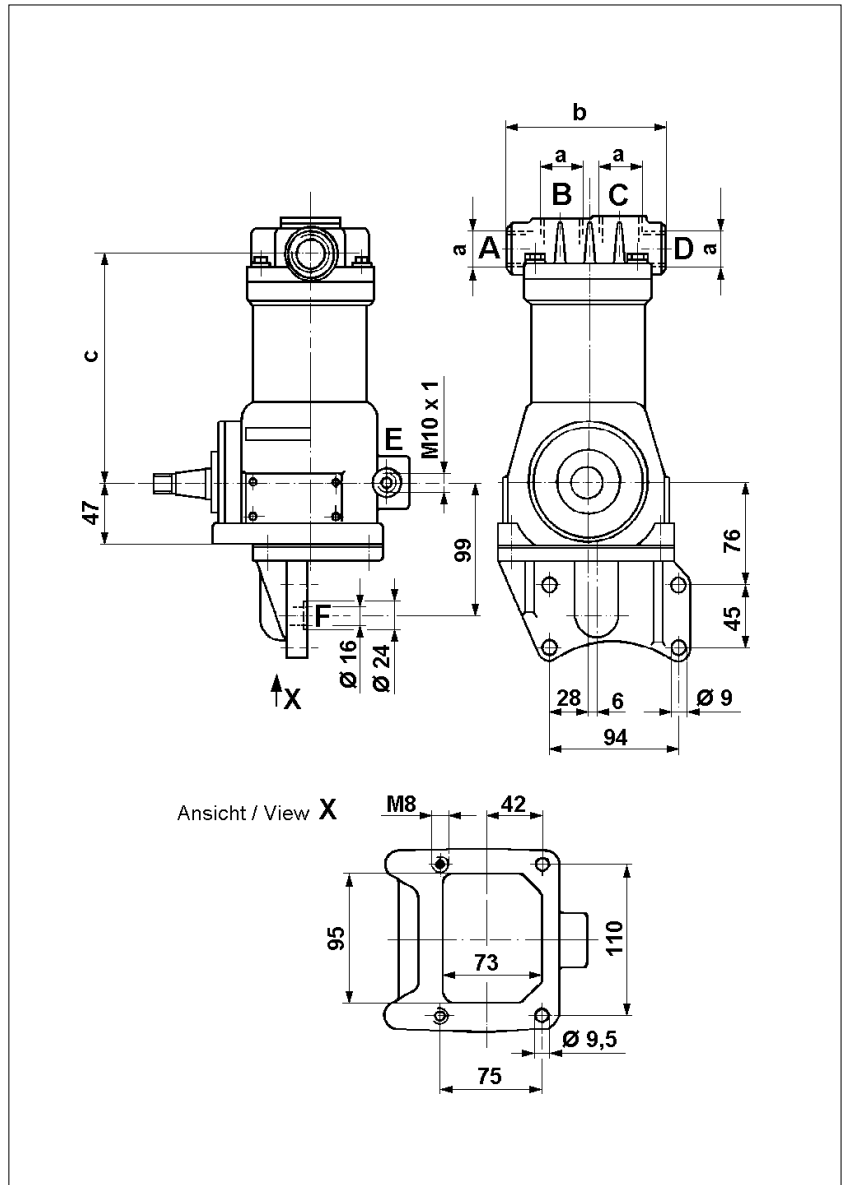

Bestellnummer Part Number	Betriebsart Operating type	Betriebsdruck Operating pressure	Drehzahl Speed	Anschlüsse / Ports						Maße / Dimensions		
				A	B	C	D	E	F	a	b	c
411 015 687 0	HDS	13 bar	2300 U/min	0	-	-	2	81	82	M 22x1,5	120	170
411 015 807 0	HDR	14 bar	2600 U/min	2	-	0	0*	81	82	M 26x1,5	120	173

* mit Stopfen verschlossen / closed with plug